

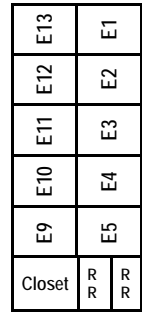

Benavon St.

Staff & Student Parking

Danby Ave.



"E" Bldg

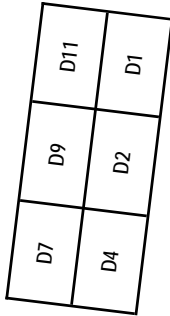

"D" Bldg

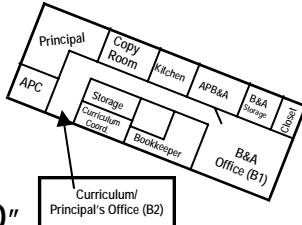

"B" Bldg

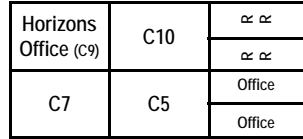

"C" Bldg

Parking

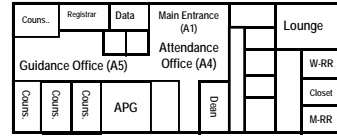

"A" Bldg

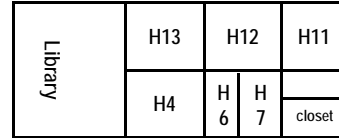

"H" Bldg

Learning Materials Office

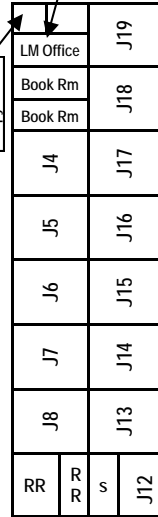

"J" Bldg

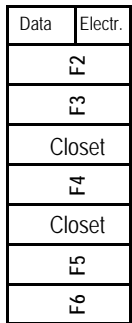

"F" Bldg

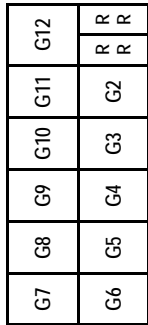

"G" Bldg

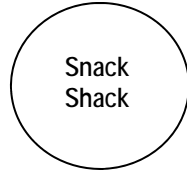

"I" Bldg

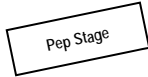
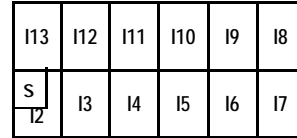

"N" Bldg

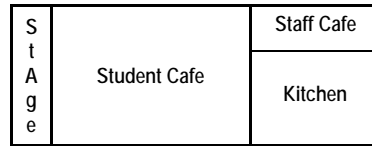

"L" Bldg



"K" Bldg

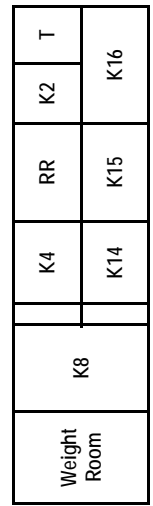

Service Road

"P" Bldg

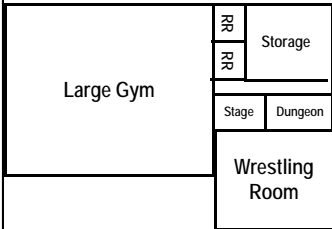
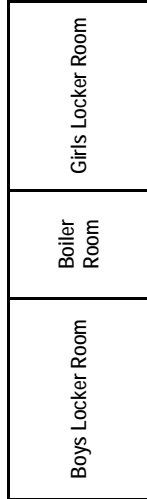
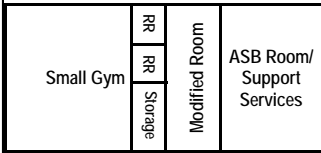

Service Road

"O" Bldg

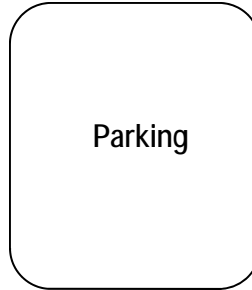
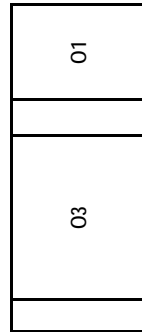

Service Road

\*\*Office Legend\*\*

(562) 698-8121

Offices:	Room:	Extension:
Principals Office	B2	5000
Business & Activities Office	B1	5010
Bookkeeper	B1	5016
Curriculum Office	B2	5020
Learning Materials Office	J2	5021
Guidance Office/Counselors	A5	5030
Attendance Office	A4	5040
Horizons Office	C9	5060
Staff Lounge/Restrooms/Mail Boxes	A5	

To Field Area

\*\*Not drawn to scale

Pioneer Blvd.

Miller Grove Drive